



- Accurate detection
- Good functions for avoiding lighting obstruction
- 3-wires NO/NC switched

■ Visible red light □ Invisible infrared

Category		Connecting	Sensing range	Models	
Detecting method	Shape			NPN	PNP
Thr-beam				2m cable	6m
Retro-reflective		3m (100mm)	S-CR300		S-CR300P
Diffuse		5~100mm	S-CR10		S-CR10P
		600mm	S-CR60		S-CR60P
BGS/FGS function		20-40mm (BGSmin)	BGS-40		BGS-40P
		20-200mm (BGSmax)	BGS-200		BGS-200P
		40-Threshold value (FGSmin)	FGS-40		FGS-40P
		200-Threshold value (FGSmax)	FGS-200		FGS-200P
		2-20mm (BGSmin)	BGS-20		BGS-20P
		2-80mm (BGSmax)	BGS-80		BGS-80P

DIMENSIONS

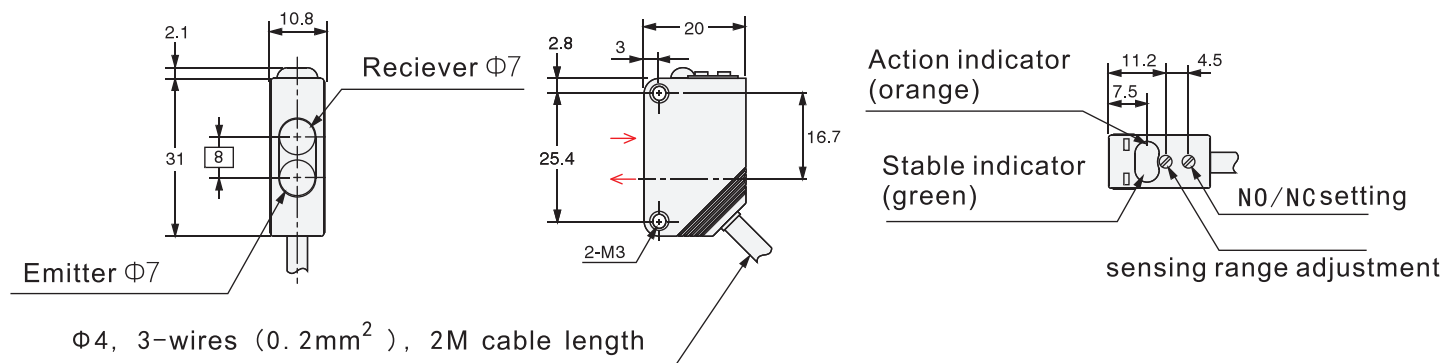

SPECIFICATIONS

MODELS	S-CR600 Series	S-CR300 Series	S-CR10 Series	S-CR60 Series
Sensing range	6m	3m	100mm	600mm
Standard sensing objects	opaque Φ 12mm	opaque Φ 12mm	100*100 white paper	300*300 white paper
Sensing differential				20% below
Sensing angle	3-15°	2-10°		
Operating voltage	12-24V (P-P \pm 10% max)			
Consuming current	Receiver: 15mA	30mA max		
	Emitter: 15mA			
Circuit protection	Power connected/output	Power connected/output, influence each other.		
Response time	1.0ms max	2.0ms max	1.0ms max	
Control output	Loading voltage 26.4V DC max			
	Loading current 100mA max (residual voltage 1Vmax)			
Light source	Red light or infrared			
Operating environment	sunlight: 10,000 lux max, filament lamp: 3,000lux Max			
	working: -25-+55°C storage: -40-+70°C No icing/dew			
	working: 35-85%RH storage: 35-95%RH			
Insulating resistance	20M Ω min. (DC500V)			
Vibration	10-55Hz double-amplitude, 1.5mmX、Y、Z each directions last for 2 hours			
Impact	Endurance	500m/s ² X、Y、Z each directions three times		
Protecting	IEC-IP67			
Material	Housing	PBT		
	Sensing surface	-		
Weight	approx.120g	approx.65g		
Accessories		Reflector		

Wiring diagram

